

GreenGuard®

Type 4 LG XPS Insulation Board

For Commercial Applications

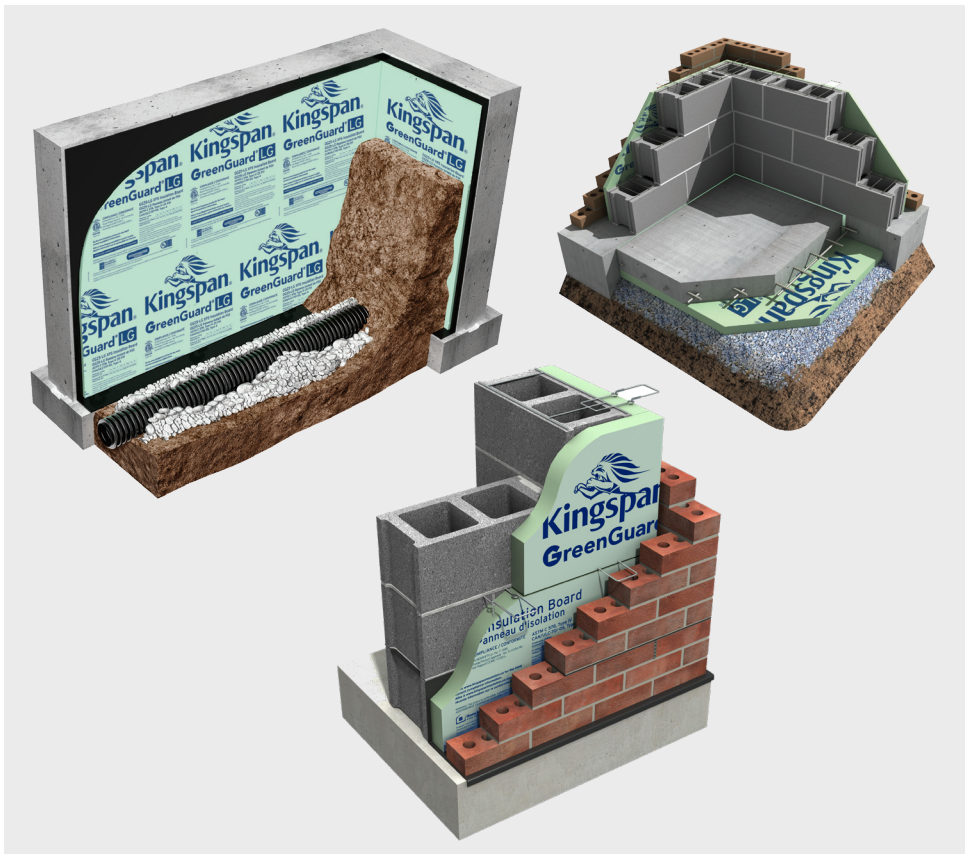

- RSI Value of 0.88 /25 mm (US R-value 5.0 per inch) of thickness
- Produced with a blowing agent blend that has a GWP of less than 50
- Available with compressive strength of 210 kPa (30.5 psi) or 276 kPa (40 psi)
- Meets or exceeds Type 4 and Types 1, 2, and 3 specifications
- High water resistance makes it an excellent choice for foundation and below-slab use

GreenGuard[®]

Type 4 LG XPS Insulation Board

Description

Kingspan GreenGuard™ Type 4 LG XPS Insulation Board comprises ½" to 3" thick closed-cell extruded polystyrene (XPS) with a minimum compressive strength of 30.5 psi or 210 kPa. Produced with a blowing agent blend that has a GWP of less than 50. It has high water resistance and an RSI Value of 0.88 / 25 mm (US R-value 5.0 per inch) of thickness. It is available in a square edge board or ship-lap edge board.

Compliance

Intertek CCRR-1021;
Intertek CCRR 1022;
UL Listings - R11183.

GreenGuard XPS is not recommended for exterior wall applications over 6 stories tall. Contact Kingspan for approved applications.

Handling & Storage

When stored outdoors, XPS should be protected from exposure to direct sunlight using the original packaging or an opaque, light-colored tarp. XPS that has been unwrapped should be covered or rewrapped. XPS left exposed should be covered within 60 days to minimize UV damage. Once the exposed XPS is covered, the damage stops and is limited to the thin layer of cells on the surface that was exposed to the UV. XPS cells below the UV exposed surface layer are generally undamaged and the XPS overall performance remains intact.

WARNING: This product is combustible. A protective barrier or thermal barrier is required as specified in the appropriate building code. Protect it from exposure to open flame or other ignition sources during shipping, storage and installation.

Health & Safety

Kingspan GreenGuard™ Type 4 LG XPS Insulation Board is made of synthetic materials that are generally not recognized as providing a food source for insects, fungus mold or mildew. It should always be properly installed and stored. For detailed safe handling and safety information, refer to the product SDS.

The product should not be used as an exposed interior surface in buildings where people can be expected to be present. An approved fire protection barrier, such as ½" gypsum wallboard or equivalent, should be applied between this product and the interior of such buildings. Fire and building codes should be followed.

All assemblies should be evaluated for effectiveness and location of vapor retarders to avoid condensation and subsequent damage to structures (ASHRAE Handbook of Fundamentals.) Since foam sheathings are non-structural, they must be installed over adequately braced framing in accordance with local building codes.

WARNING: Do not stand on or otherwise support your weight on this product unless it is fully supported by a load bearing surface.

To ensure you are viewing the most recent and accurate product information, please visit this link <https://www.kingspan.com/ca/en/products/rigid-insulation/insulation-board/>

For more information on specific building product recommendations and installation guidelines, contact your Kingspan Insulation LLC representative.

Product Data			
Property	Test Method	Value	
General			
		30.5 psi	40 psi
Thickness	Millimeter	12.7, 19.1, 25.4, 38.1, 50.8, 63.5, 76.2, 101.6,	50.8, 76.2, 101.6,
Thickness	Inch	½, ¾, 1, 1½, 2, 2½, 3, 4	2, 3, 4
Type ¹	CAN /ULC-S701	4	4
Compressive Strength Min. (kPa @ 10% Deflection) (psi @ 10% Deflection)		210 30.5	276 40
Water Absorption Max. (% by volume)	ASTM C272	0.3	0.3
Water Vapor Permeance ng/Pa-s-m ² Perm ²	ASTM E96 (Desiccant Method)	86 1.5	63 1.1
Dimensional Stability Max. (Linear % Change)	ASTM D2126	2.0	2.0
Flexural Strength (kPa) (psi)	ASTM C203	350 51	414 60
Service Temperature Max. °C		73	73
Thermal			
Thermal Resistance R-value ³ (m ² -K/W) (°F-ft ² hr /Btu)	ASTM C518 (@75° Mean Temperature)	0.88 per 25mm 5.0 per inch	0.88 per 25mm 5.0 per inch
Fire & Smoke			
Flame Spread ⁴ Smoke Developed ⁴	ASTM E84/UL723	25 (Class A) 140	

¹Kingspan GreenGuard Type 4 LG XPS Insulation Board meets or exceeds Types 1, 2, and 3 according to CAN/ULC S701.1

²Permeance shown for 1 inch thick (25.4mm) board. Permeance typically decreases as board thickness increases.

³Specimens are aged and tested in accordance with the FTC Rule (16 CFR, Part 460) and ASTM C578. Kingspan GreenGuard XPS insulation complies with the long term thermal resistance (LTTR) requirements of the CAN/ULC S701.1 Standard for Thermal Insulation, Polystyrene Boards. R-values listed are in accordance with the testing requirements of ASTM C578 and are based on 1" aged product for 30.5psi and 2" product for 40 psi material at 75oF mean temperature.

⁴These numerical flame spread and smoke developed ratings are not intended to reflect hazards presented by this material under actual fire conditions. All applicable building codes must be followed.

Kingspan Insulation LLC believes the information and recommendations herein to be accurate and reliable. However, since use conditions are not within its control, Kingspan Insulation LLC does not guarantee results from use of such products or other information herein and disclaims all liability from any resulting damage or loss. No warranty, express or implied, is given as to the merchantability, fitness for particular purpose, or otherwise with respect to the products referred to.

Kingspan Insulation LLC

2100 Riveredge Parkway | Suite 175

Atlanta | Georgia 30328

T: +1 (800) 241 4402 F: +1 (678) 589 7325

E: info@kingspaninsulation.us

www.kingspaninsulation.us

© Kingspan, the G Device and the Lion Device are Registered Trademarks of the Kingspan Group plc in the US, Canada and other countries. All rights reserved.® GreenGuard is a Registered Trademark of the Kingspan Group plc in the US. All rights reserved.

kingspan-green-guard-type4lg-commercial-product-data-sheet-en-ca-v7.2

Version 7.2 - 11/2024

